

INGROUND ALU 17W MEDIUM

INGROUND SERIES

PRECILUM®
SPECIAL LED LIGHTING SOLUTIONS



INTRODUCTION

SAVE ENERGY WITH PRECILUM

The INGROUND ALU series was designed for the most demanding customers who seek non standard solutions.

- Based on CREE® LEDs
- 230V AC
- Made of 316L steel with aluminium
- Power: 17W
- IP67
- 5 year warranty

APPLICATIONS

INGROUND ALU 17W MEDIUM

The PRECILUM ALU Medium fixture can be used for lighting many places and objects such as:

- parks
- gardens
- squares
- premises
- plants
- exterior walls

SPECIFICATION

LIGHT COLOUR	CONFORT WHITE	WARM WHITE	NEUTRAL WHITE	COOL WHITE
Colour Temperature *	2700 ± 150 K	3000 ± 150 K	4000 ± 250 K	5000 ± 250 K
Effective Lumen Output **	1250 lm	1250 lm	1450 lm	1450 lm
CRI	≥ 80			
Viewing Angle [FWHM]	25°, 50°			
Input Voltage	230V AC 50Hz			
Power Consumption	17W			
Operating Temperature	-20°C ÷ +55°C			
Dimensions	Ø 148 mm			
Cable Type	H07RN-F 3G1			
Cable Length	0.5 m			
IP Rating	IP67			
Lifetime ***	≥ 60 000 h			

* Other CCTs and colours available on request.

** Source performance in real life conditions at Ta=25°C; includes optical losses; the tolerance of source lumen output is 5%.

*** Approximate lifetime of LEDs declared by Cree® at Ta=25°C (for 90% of initial light output) and other electronic components (for 90% of initial light output) and other electronic components.

INGROUND ALU 17W MEDIUM

INGROUND SERIES

PRECILUM[®]
SPECIAL LED LIGHTING SOLUTIONS

DIMENSIONS [MM]

ROUND FRONT

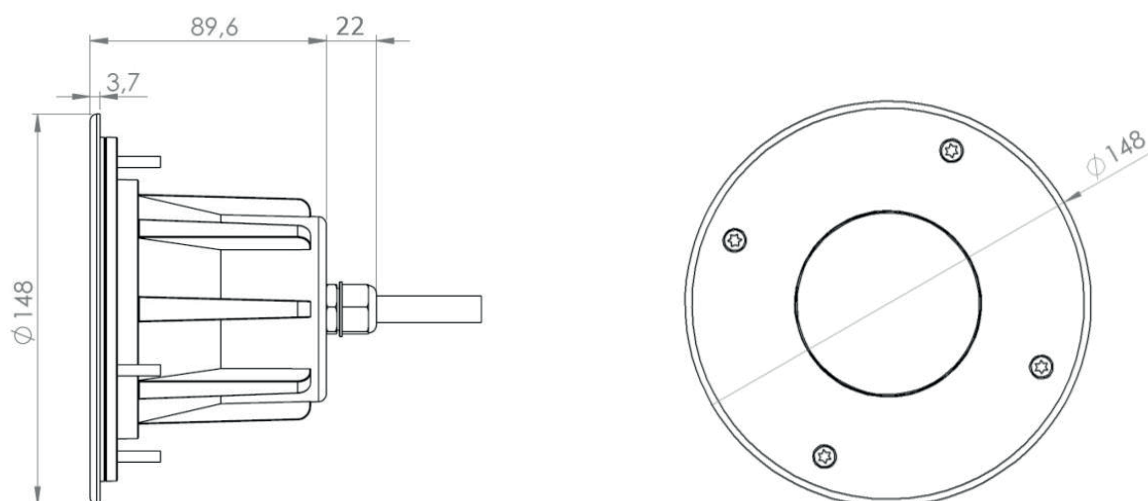

ACCESORIES

INGROUND MEDIUM ABS

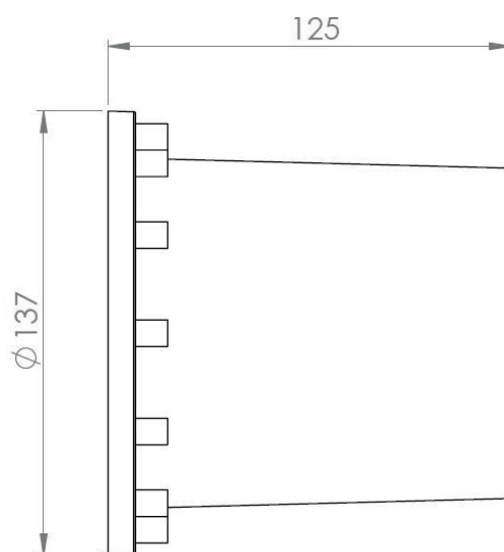

ELECTRICAL INSTALLATION

CONNECTION

Connecting to the power supply should be done when the power supply is off.

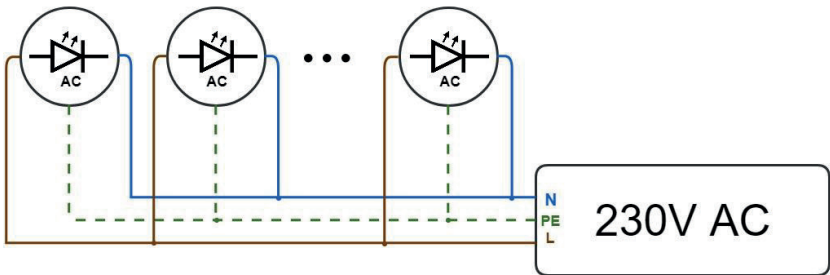

ORDER CODE FORMAT

EXPLANATION

FAMILY	POWER		FWHM ANGLE		MATERIAL OF THE FRONT / BODY							
ALU MEDIUM	-	17	-	VW	-	25	-	RD	-	SA	-	HV
				CCT				FRONT PLATE				SUPPLY VOLTAGE
				VW – 2700K				RD – Round				HV – 230V AC, 50Hz
				WW – 3000K								
				NW – 4000K								
				CW – 5000K								

ENVIRONMENTAL CAUTION

CAUTION!



It is prohibited to dispose of obsolete and waste electrical and electronic equipment together with regular household wastes. They should be properly sorted and recycled. Old electrical and electronic equipment should be returned to a waste collection point established by a waste management service. Waste electrical and electronic equipment can be broken down to base materials and then recycled. For more information regarding waste management please contact your local authorities, waste management service or the seller of electrical and electronic devices.